

# TS-22A

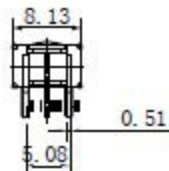

## P.C.B MOUNTING DIMENSION

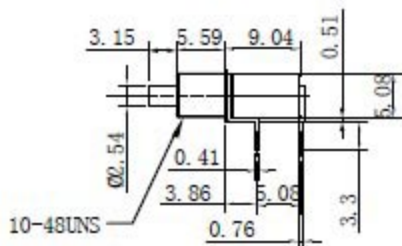
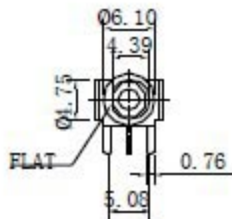
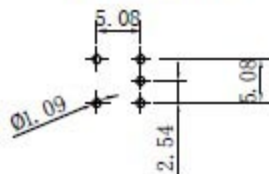

## FEATURES:

CONTACT RATING: 1A @ 120 VAC or 28 VDC  
 ELECTRICAL LIFE: 60,000 make-and-break cycles at full load  
 CONTACT RESISTANCE: 20m Ω max. initial @ 2-4VDC, 100mA  
 INSULATION RESISTANCE: 1,000M Ω min.  
 DIELECTRIC STRENGTH: 1,600V RMS @ sea level.  
 OPERATING TEMPERATURE: -50 °C to 86 °C

## SCHEMATIC

