

TS-22

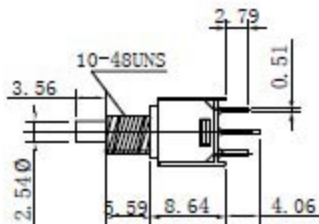
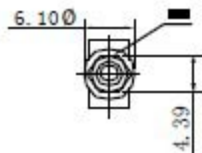

FEATURES:

CONTACT RATING: 1A @ 120 VAC or 28 VDC

ELECTRICAL LIFE: 50,000 make-and-break cycles at full load

CONTACT RESISTANCE: 20m Ω max. initial @ 2-4VDC, 100mA

INSULATION RESISTANCE: 1,000M Ω min.

DIELECTRIC STRENGTH: 1,600V RMS @ sea level.

OPERATING TEMPERATURE: -30 °C to 85 °C

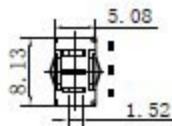

PC terminal

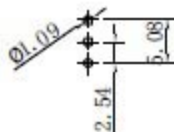

SCHEMATIC



CALUS