

RS-8

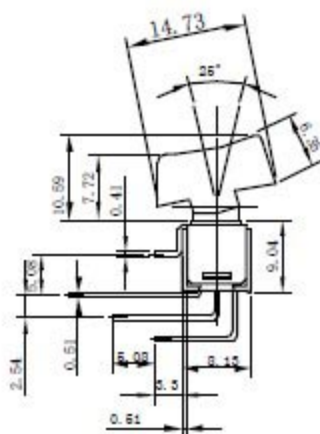

P.C.B. MOUNTING DIMENSION

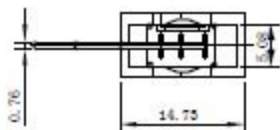
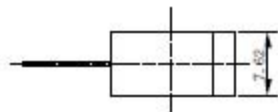
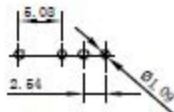

FEATURES:

- CONTACT RATING: 5A @ 120 VAC or 2S VDC (q: terminal option)
- ELECTRICAL LIFE: 30,000 make-and-break cycles at full load
- CONTACT RESISTANCE: 20m Ω max. initial @ 2-4 VDC, 100mA
- INSULATION RESISTANCE: 1,000M Ω min.
- DIELECTRIC STRENGTH: 1,500V RMS @ sea level.
- OPERATING TEMPERATURE: -30 °C to 85 °C

