

# R8017

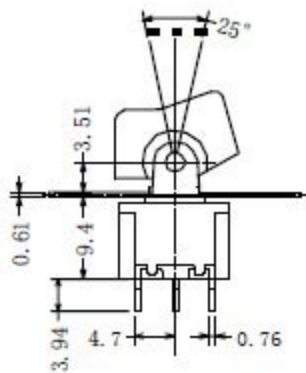

## FEATURES:

CONTACT RATING: 5A @ 120 VAC or 28 VDC (Q terminal)  
 ELECTRICAL LIFE: 50,000 make-and-break cycles at full load  
 CONTACT RESISTANCE: 10m Ω max. initial @ 2-4 VDC, 100mA  
 INSULATION RESISTANCE: 1,000M Ω min.  
 DIELECTRIC STRENGTH: 1,500V RMS @ sea level.  
 OPERATING TEMPERATURE: -30 °C to 85 °C

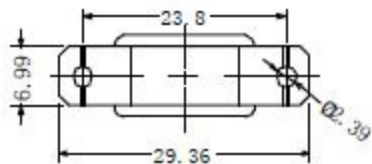
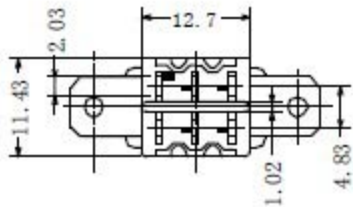

## CUT-OUT

