

R8015

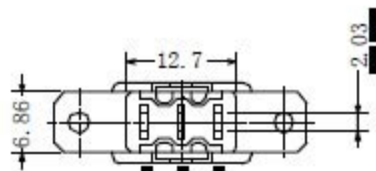

FEATURES:

CONTACT RATING: 5A @ 120 VAC or 25 VDC (Q terminal)
ELECTRICAL LIFE: 60,000 make-and-break cycles at full load
CONTACT RESISTANCE: 10m Ω max. initial @ 2-4 VDC, 100mA
INSULATION RESISTANCE: 1,000M Ω min.
DIELECTRIC STRENGTH: 1,500V RMS @ sea level.
OPERATING TEMPERATURE: -30 °C to 85 °C

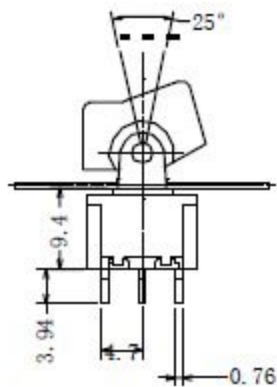
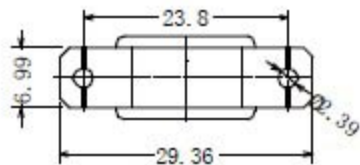
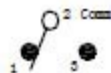
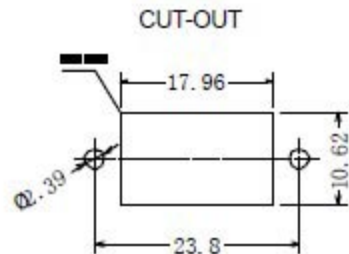

UL US